

NOTE: ITEMS MARKED '\*' INDICATE SHIMS  
NOT REQUIRED WITH SHIMLESS DIFFUSER  
PART No: 08391076A [ITEM #76a]

Title **PUMPENG 8kW  
HIGH HEAD SUBMERSIBLE  
DEWATERING PUMP**

Rev. 2 Sept. '07

SUPPLIED BY:

INFORMATION ON THIS DOCUMENT IS SUBJECT TO CHANGE WITHOUT NOTICE



Unit 2/26 Ilda Rd.  
Canning Vale. W.A. 6155  
PO Box 1340  
Canning Vale. W.A. 6970

Ph: 61 8 9256 3182  
Fax: 61 8 9256 3867  
Email: [sales@pumpeng.com.au](mailto:sales@pumpeng.com.au)  
Web: [www.pumpeng.com.au](http://www.pumpeng.com.au)

WITHOUT LIMITING THE RIGHTS UNDER  
COPYRIGHT, NO PART OF THIS DOCUMENT  
MAY BE REPRODUCED, STORED IN OR  
INTRODUCED TO A RETRIEVAL SYSTEM,  
OR TRANSMITTED IN ANY FORM OR BY  
ANY MEANS, OR FOR ANY PURPOSE,  
WITHOUT THE EXPRESS WRITTEN  
PERMISSION OF PUMPENG.

ACCESSORIES		
PART No.	DESCRIPTION	CONSISTS OF:
08SK	8kW Rotor Shaft Kit	Item #62C – O-Rings Item #62B – Sleeve Item #62D – Circlip

ACCESSORIES		
PART No.	DESCRIPTION	CONSISTS OF:
08BSK	8kW Bottom Suction Kit	Item #65A – Btm. Suct. Strainer Item #65B – Half Strainer Item #65C – Bolt

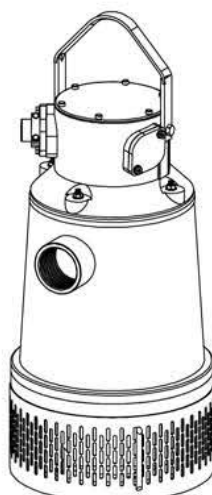

ACCESSORIES		
PART No.	DESCRIPTION	CONSISTS OF:
08RK	8kW Repair Kit	Item #2 – Seal Item #13 – Seal Item #103 – Circlip Item #122 – Bearing Item #123 – Bearing + 1x O-Ring Kit #08OK

ACCESSORIES		
PART No.	DESCRIPTION	CONSISTS OF:
08OK	8kW O-Ring Kit	Item #33b – O-Ring Item #104 – O-Ring Item #105 – O-Ring Item #107 – O-Ring Item #111 – O-Ring Item #112 – O-Ring Item #113 – O-Ring Item #114 – O-Ring Item #115 – O-Ring

## ENHANCED PERFORMANCE PARTS

ITEM No.	PART No.	DESCRIPTION	MATERIAL	QTY.	ITEM No.	PART No.	DESCRIPTION	MATERIAL	QTY.
1	08120001	Impeller Nut	S/Steel	1	71	08201071	Diffuser Disc	Poly	1
2	08128002	Mechanical Seal	TC	1	72	08130072	Screw Inspection	S/Steel	3
11	08120011	Shim Impeller 0.3mm	S/Steel	–	74	08200074	Stator 415V	–	1
11a	08120011A	Shim Impeller 1.5mm	S/Steel	–	74a	08200074A	Stator 1000V	–	1
12	08120012	Shim Diffuser 0.3mm	S/Steel	–	76	08291076	Diffuser	Alum/Poly	1
12a	08120012A	Shim Diffuser 0.5mm	S/Steel	–	76a	08291076A	Diffuser Shimless	Alum/Poly	1
13	08128002	Mechanical Seal	TC	1	76b	08190076B	Diffuser Adjusting Screw	Aluminium	6
21	08190021	Cable Entry Unit 14–22mm	Aluminium	1	82	08130082	Impeller Key	S/Steel	1
21a	08190021A	Junction Box Flange	Aluminium	1	84	08120084	Stud	S/Steel	4
21b	08190021B	Cable Flange Gasket	N.A.G.	1	85	08120085	Stud	S/Steel	6
27	08120027	Sleeve Washer 14–16mm	S/Steel	2	86a	08120086A	Stud	S/Steel	6
27a	08120027A	Sleeve Washer 16–18mm	S/Steel	2	86b	08120086B	Stud	S/Steel	4
27b	08120027B	Sleeve Washer 18–20mm	S/Steel	2	87	08120087	Screw	S/Steel	4
27c	08120027C	Sleeve Washer 20–22mm	S/Steel	2	88	08120088	Screw	S/Steel	2
31	08102031	Seal Sleeve 14–16mm	Rubber	1	89	08120089	Screw	S/Steel	2
31a	08102031A	Seal Sleeve 16–18mm	Rubber	1	90	08120090	Screw	S/Steel	11
31b	08102031B	Seal Sleeve 18–20mm	Rubber	1	91	08120091	Screw	S/Steel	4
31c	08102031C	Seal Sleeve 20–22mm	Rubber	1	93	08120093	Screw	S/Steel	1
33	08190033	Junction Box	Aluminium	1	95	08120095	Nut	S/Steel	4
33a	08190033A	Junction Box Cover	Aluminium	1	96	08120096	Nut	S/Steel	48
33b	08190033B	O-Ring Junction Box	NBR	1	97	08120097	Washer	S/Steel	4
34	08630034	Outer Casing	S/Steel	1	98	08120098	Washer	S/Steel	1
35	08630035	Stator Casing	Aluminium	1	101	08120101	Washer	S/Steel	42
36	08190036	Bearing Housing Lower	Aluminium	1	102	08120102	Washer Spring	S/Steel	4
41	08191041	Oil Housing	Alum/Poly	1	103	08120103	Circlip	HTS	1
43	08291043	Suction Cover HT	Alum/Poly	1	104	08100104	O-Ring	NBR	3
44	08190044	Bearing Housing Upper	Aluminium	1	105	08100105	O-Ring	NBR	1
45	08190045	Bearing Cover	Aluminium	1	107	08100107	O-Ring	NBR	1
56	08710056	Impeller Lower HT – Std.	Cr27	1	111	08100111	O-Ring	NBR	1
56a	08710056A	Impeller Lower c/w Bush	Cr27	1	112	08100112	O-Ring	NBR	1
56b	08710056B	Impeller Lower Neck Bush	Cr16	1	113	08100113	O-Ring	NBR	1
57	08710057	Impeller Upper HT	Cr27	1	114	08100114	O-Ring	NBR	1
62	08100062	Rotor – Standard	S/Steel	1	115	08100115	O-Ring	NBR	1
62a	08100062A	Rotor – Modified for Shaft Sleeve option	S/Steel	1	117	08100117	Washer Bearing Support	S/Steel	1
62b	08100062B	Shaft Sleeve – suit Modified Rotor Shaft	S/Steel	1	122	08100122	Bearing Upper	–	1
62c	08100062C	O-Ring – suit Shaft Sleeve	NBR	2	123	08100123	Bearing Lower	–	1
62d	08120062D	Shaft Sleeve – Circlip	S/Steel	2	126	08100126	Earthing Plate	S/Steel	1
63	08102063	Lead Through	Rubber	1	131	08100131	Handle	Galv. St.	1
65	08100065	Standard Strainer	Galv/St	1	139	GP2400139	Anode	Zinc	4
65a	08100065A	Bottom Suction Strainer	Galv/St	1	140	08600140	Carry Handle	Galv/St	1
65b	08100065B	Half Strainer	Galv/St	1	141	08120141	Screw	S/Steel	6
65c	08100065C	Bolt	Galv/St	3	142	08120142	Washer	S/Steel	6

Title **PUMPENG 8kW  
HIGH HEAD SUBMERSIBLE  
DEWATERING PUMP**

SUPPLIED BY:

Rev. 3 Sept. '07

INFORMATION ON THIS DOCUMENT IS SUBJECT TO CHANGE WITHOUT NOTICE



Unit 2/26 Ilda Rd.  
Canning Vale. W.A. 6155  
PO Box 1340  
Canning Vale. W.A. 6970

Ph: 61 8 9256 3182  
Fax: 61 8 9256 3867  
Email: sales@pumpeng.com.au  
Web: www.pumpeng.com.au

WITHOUT LIMITING THE RIGHTS UNDER COPYRIGHT, NO PART OF THIS DOCUMENT MAY BE REPRODUCED, STORED IN OR INTRODUCED TO A RETRIEVAL SYSTEM, OR TRANSMITTED IN ANY FORM OR BY ANY MEANS, OR FOR ANY PURPOSE, WITHOUT THE EXPRESS WRITTEN PERMISSION OF PUMPENG.



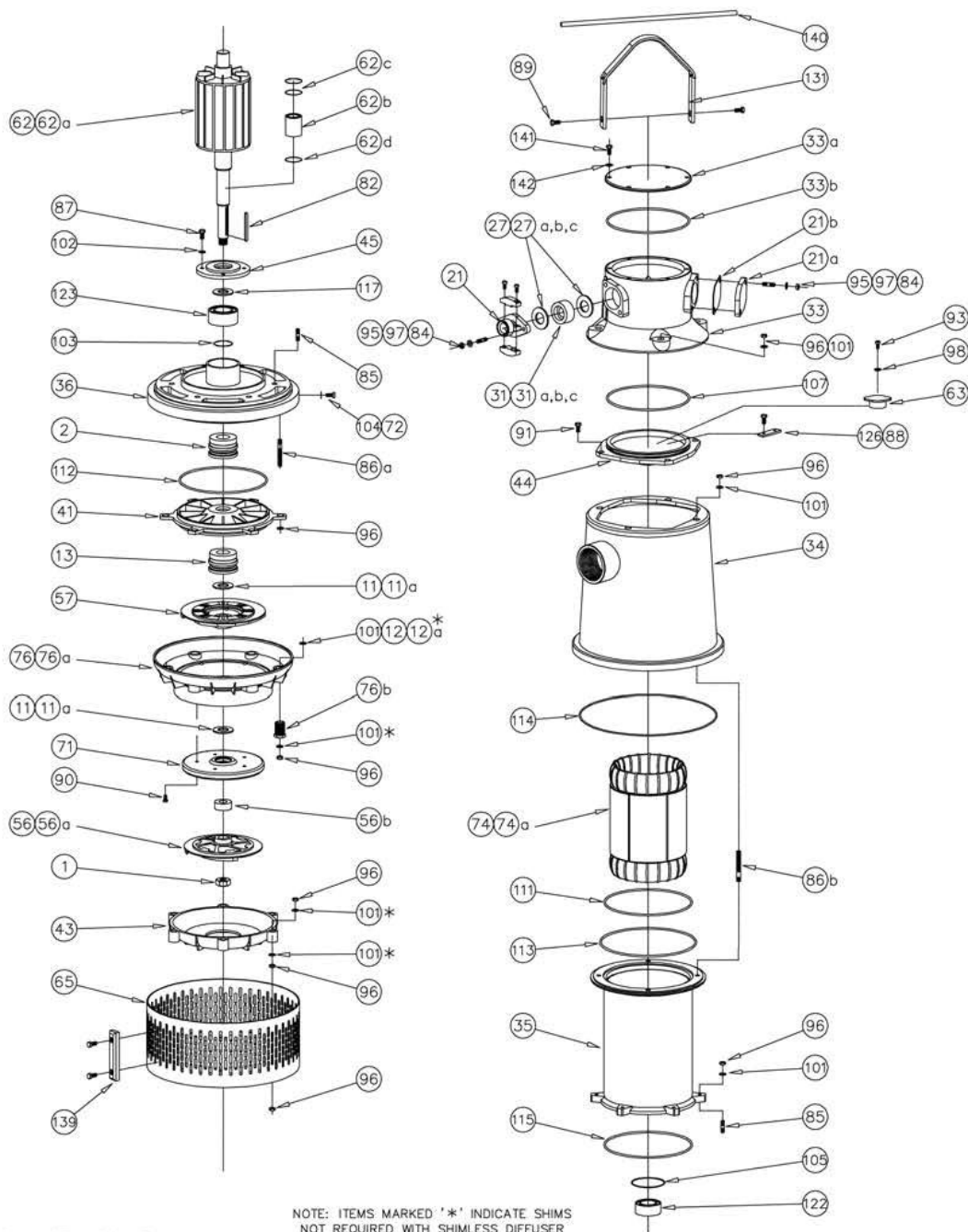

DO NOT SCALE

ACCESSORIES		
PART No.	DESCRIPTION	CONSISTS OF:
08SK	8kW Rotor Shaft Kit	Item #62C - O-Rings Item #62B - Sleeve Item #62D - Circlip

ACCESSORIES		
PART No.	DESCRIPTION	CONSISTS OF:
08BSK	8kW Bottom Suction Kit	Item #65A - Btm. Suct. Strainer Item #65B - Half Strainer Item #65C - Bolt



ACCESSORIES		
PART No.	DESCRIPTION	CONSISTS OF:
08RK	8kW Repair Kit	Item #2 - Seal Item #13 - Seal Item #103 - Circlip Item #122 - Bearing Item #123 - Bearing + 1x O-Ring Kit #08OK

ACCESSORIES		
PART No.	DESCRIPTION	CONSISTS OF:
08OK	8kW O-Ring Kit	Item #33b - O-Ring Item #104 - O-Ring Item #105 - O-Ring Item #107 - O-Ring Item #111 - O-Ring Item #112 - O-Ring Item #113 - O-Ring Item #114 - O-Ring Item #115 - O-Ring

ENHANCED PERFORMANCE PARTS											
ITEM No.	PART No.	DESCRIPTION	MATERIAL	QTY.	ITEM No.	PART No.	DESCRIPTION	MATERIAL	QTY.	ITEM No.	PART No.
1	08120001	Impeller Nut	S/Steel	1	71	08201071	Diffuser Disc	Poly	1		
2	08128002	Mechanical Seal	TC	1	72	08130072	Screw Inspection	S/Steel	3		
11	08120011	Shim Impeller 0.3mm	S/Steel	-	74	08200074	Stator 415V	-	1		
11a	08120011A	Shim Impeller 1.5mm	S/Steel	-	74a	08200074A	Stator 1000V	-	1		
12	08120012	Shim Diffuser 0.3mm	S/Steel	-	76	08291076	Diffuser	Alum/Poly	1		
12a	08120012A	Shim Diffuser 0.5mm	S/Steel	-	76a	08291076A	Diffuser Shimless	Alum/Poly	1		
13	08128002	Mechanical Seal	TC	1	76b	08190076B	Diffuser Adjusting Screw	Aluminium	6		
21	08190021	Cable Entry Unit 14-22mm	Aluminium	1	82	08130082	Impeller Key	S/Steel	1		
21a	08190021A	Junction Box Flange	Aluminium	1	84	08120084	Stud	S/Steel	4		
21b	08190021B	Cable Flange Gasket	N.A.G.	1	85	08120085	Stud	S/Steel	6		
27	08120027	Sleeve Washer 14-16mm	S/Steel	2	86a	08120086A	Stud	S/Steel	6		
27a	08120027A	Sleeve Washer 16-18mm	S/Steel	2	86b	08120086B	Stud	S/Steel	4		
27b	08120027B	Sleeve Washer 18-20mm	S/Steel	2	87	08120087	Screw	S/Steel	4		
27c	08120027C	Sleeve Washer 20-22mm	S/Steel	2	88	08120088	Screw	S/Steel	2		
31	08102031	Seal Sleeve 14-16mm	Rubber	1	89	08120089	Screw	S/Steel	2		
31a	08102031A	Seal Sleeve 16-18mm	Rubber	1	90	08120090	Screw	S/Steel	11		
31b	08102031B	Seal Sleeve 18-20mm	Rubber	1	91	08120091	Screw	S/Steel	4		
31c	08102031C	Seal Sleeve 20-22mm	Rubber	1	93	08120093	Screw	S/Steel	1		
33	08190033	Junction Box	Aluminium	1	95	08120095	Nut	S/Steel	4		
33a	08190033A	Junction Box Cover	Aluminium	1	96	08120096	Nut	S/Steel	48		
33b	08190033B	O-Ring Junction Box	NBR	1	97	08120097	Washer	S/Steel	4		
34	08630034	Outer Casing	S/Steel	1	98	08120098	Washer	S/Steel	1		
35	08630035	Stator Casing	Aluminium	1	101	08120101	Washer	S/Steel	42		
36	08190036	Bearing Housing Lower	Aluminium	1	102	08120102	Washer Spring	S/Steel	4		
41	08191041	Oil Housing	Alum/Poly	1	103	08120103	Circlip	HTS	1		
43	08291043	Suction Cover HT	Alum/Poly	1	104	08100104	O-Ring	NBR	3		
44	08190044	Bearing Housing Upper	Aluminium	1	105	08100105	O-Ring	NBR	1		
45	08190045	Bearing Cover	Aluminium	1	107	08100107	O-Ring	NBR	1		
56	08710056	Impeller Lower HT - Std.	Cr27	1	111	08100111	O-Ring	NBR	1		
56a	08710056A	Impeller Lower c/w Bush	Cr27	1	112	08100112	O-Ring	NBR	1		
56b	08710056B	Impeller Lower Neck Bush	Cr16	1	113	08100113	O-Ring	NBR	1		
57	08710057	Impeller Upper HT	Cr27	1	114	08100114	O-Ring	NBR	1		
62	08100062	Rotor - Standard	S/Steel	1	115	08100115	O-Ring	NBR	1		
62a	08100062A	Rotor - Modified for Shaft Sleeve option	S/Steel	1	117	08100117	Washer Bearing Support	S/Steel	1		
62b	08100062B	Shaft Sleeve - suit Modified Rotor Shaft	S/Steel	1	122	08100122	Bearing Upper	-	1		
62c	08100062C	O-Ring - suit Shaft Sleeve	NBR	2	123	08100123	Bearing Lower	-	1		
62d	08120062D	Shaft Sleeve - Circlip	S/Steel	2	126	08100126	Earthing Plate	S/Steel	1		
63	08102063	Lead Through	Rubber	1	131	08100131	Handle	Galv. St.	1		
65	08100065	Standard Strainer	Galv/St	1	139	GP2400139	Anode	Zinc	4		
65a	08100065A	Bottom Suction Strainer	Galv/St	1	140	08600140	Carry Handle	Galv/St	1		
65b	08100065B	Half Strainer	Galv/St	1	141	08120141	Screw	S/Steel	6		
65c	08100065C	Bolt	Galv/St	3	142	08120142	Washer	S/Steel	6		

NOTE: ITEMS MARKED '\*' INDICATE SHIMS NOT REQUIRED WITH SHIMLESS DIFFUSER  
PART No: 08391076A [ITEM #76a]

SUPPLIED BY:

Title **PUMPENG 8kW  
HIGH HEAD SUBMERSIBLE  
DEWATERING PUMP**



Unit 2/26 Ilda Rd.  
Canning Vale. W.A. 6155  
PO Box 1340  
Canning Vale. W.A. 6970

Ph: 61 8 9256 3182  
Fax: 61 8 9256 3867  
Email: sales@pumpeng.com.au  
Web: www.pumpeng.com.au

INFORMATION ON THIS DOCUMENT IS SUBJECT TO CHANGE WITHOUT NOTICE

Rev. 3 Sept. '07